

**DLH**ONLINE



**Yale*****ERGO*** **360**

FOR OPTIMAL EFFICIENCY AND SAFETY

# Yale **ERGO** 360

**Capacity 750 - 6000kg**

Redefining lever-operated hoists, the Yale **ERGO** 360 features the revolutionary crank handle that allows for efficient operation in both lifting and pulling applications.

Ergonomically designed for increased safety, the patent-pending Yale **ERGO** 360 lets the operator work up to 12 times faster and with as much as 30% less effort than with conventional ratchet lever tools.

- **CRANK HANDLE**  
First-of-its-kind lever handle design will revolutionise the ratchet lever hoist industry. Unique foldable lever handle and 360° rotating action increases productivity while reducing risk of operator injury.
- **CONVENIENT DIRECTIONAL INDICATOR**  
Easy-to-use, highly visible directional indicator on the handle clearly shows operating direction as lifting, lowering or neutral.
- **EASY & SMOOTH FREE CHAINING**  
Quick take up and positioning of slack chain – even with one hand. Designed not to accidentally free chain while under load. Cast chain end stop allows user to easily position the chain in free-chaining mode and prevents it from entering the liftwheel.
- **POSITIVE LOAD CONTROL**  
Enclosed Weston-type brake for precise load positioning.
- **BUILT TO LAST**  
Lightweight aluminum housing withstands rigorous use and features high-quality, long-lasting bearings. Powder coat finish provides extra protection in harsh environments.
- **EXCELLENT CORROSION PROTECTION**  
Robust chain guide and chain stripper made from cast steel and zinc-plated for corrosion protection.
- **EASY-TO-INSPECT SWIVEL HOOKS**  
Bolt on hooks with nyloc nuts to simplify the inspection process. Hooks are forged, allowing them to yield under overload without breaking. Cast safety latches provide positive and secure load engagement.



**360°**

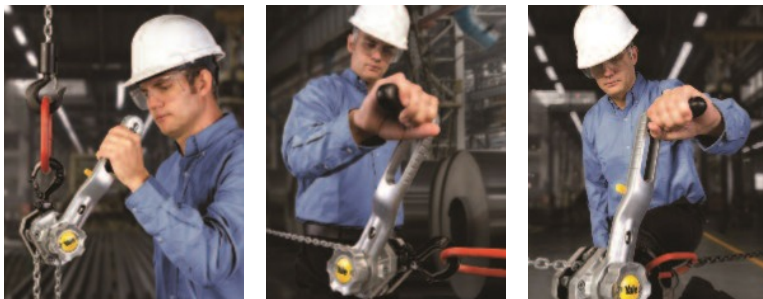

PATENT PENDING  
**CRANK HANDLE**  
DESIGNED FOR OPTIMAL  
EFFICIENCY & SAFETY

## REVOLUTIONARY CRANK HANDLE

- 360° rotation increases efficiency, allowing operators to work up to 12 times faster than with a conventional ratchet lever hoist.
- Requires 30% less effort to operate.
- Easy and effective operation from any angle with handle that folds down and locks into position on either side of the lever.
- Design keeps the operator's body aligned with the load chain, reducing the risk of the twist effect – when a hoist twists around the chain. No need to use a second hand to stabilize the hoist.
- Operator can securely grip the grooved, no-slip handle.
- Crank handle made of durable polyamide with a heavy-duty steel core for rugged use.



**DISTINCTIVE  
(((CLICKING SOUND)))**  
**ENSURES THE HANDLE  
IS LOCKED INTO POSITION**

To return handle to upright position, simply pull the handle outward and snap into place inside the lever.

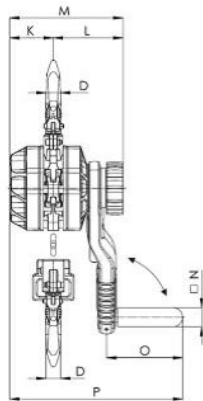
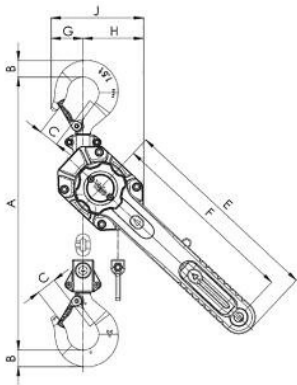
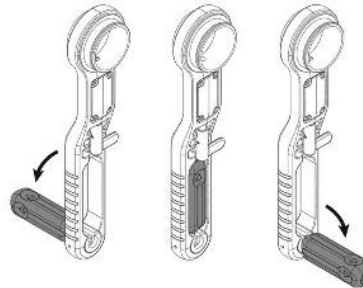

Model YaleERGO 360, 750 - 3000kg, single fall

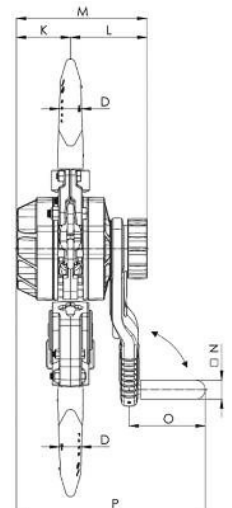
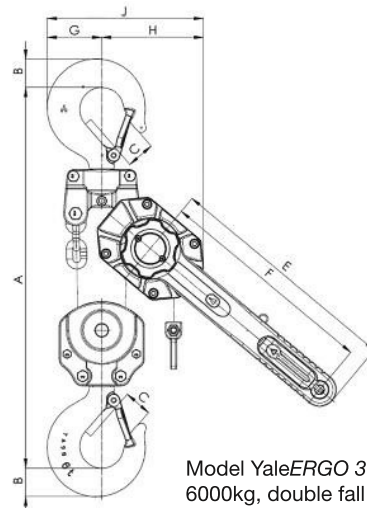

Model YaleERGO 360, 6000kg, double fall

## YaleERGO 360

Model kg	A min. mm	B mm	C mm	D mm	E mm	F mm	G mm	H mm	J mm	K mm	L mm	M mm	N □ mm	O mm	P mm
750	320	20	27	18	327	300	40	81	121	56	105	161	30	120	257
1500	375	26	31	21	327	300	51	96	147	69	110	179	30	120	273
3000	445	37	40	28	377	350	57	123	180	86	121	207	30	120	299
6000	563	45	44	35	377	350	87	162	238	86	121	207	30	120	299

Model	Capacity (WLL) kg	Falls of load chain	Chain dimensions mm	Lifting height mtr	Closed height mm	Handle effort at WLL daN	Weight @ std.HOL £
ERGO 750	750	1	5.6 x 17.1	1.5	320	20	6.6
ERGO 1500	1500	1	7.1 x 21	1.5	375	26	9.5
ERGO 3000	3000	1	10 x 28	1.5	445	40	16.8
ERGO 6000	6000	2	10 x 28	1.5	563	42	28.6

**DLH**ONLINE



# Yale **ERGO** 360

Dale Lifting and Handling Specialists  
2 Kelbrook Road, Parkhouse Street Industrial Estate, Manchester, M11 2QA  
Telephone 0161 223 1990 Email [sales@dale-lifting.co.uk](mailto:sales@dale-lifting.co.uk)